

Sandy Town Council

To: Cllrs N Aldis, J Ali, C Butterfield, W Jackson, K Lynch, A Maycock, M Runchman, R Smith, S Sutton, and S Walsh

Cc: Cllrs C Osborne, M Pettitt, D Sharman, M Scott and G White

You are hereby summoned to attend a meeting of the Community Services and Environment Committee of Sandy Town Council which will be held in the Council Chamber at 10, Cambridge Road, Sandy, Bedfordshire on Monday 23 September 2013 commencing at 7.30 pm. The items of business to be transacted are specified below.

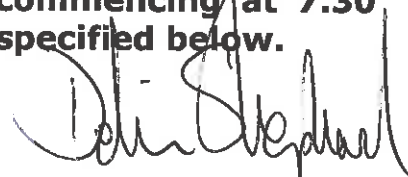

Delia Shephard
Town Clerk
10 Cambridge Road, Sandy
SG19 1JE
01767 681491
17 September 2013

A G E N D A

- | | Reports |
|--|------------------------------|
| 1 Apologies for absence | x |
| 2 Declarations of interest and requests for dispensations
<i>Under the Localism Act 2011 members of Council are not required to make oral declarations of interest at meetings but may not participate in discussion or voting on any items of business in which they have a Declarable Pecuniary Interest (DPI) and under Sandy Town Council's Standing Orders must leave the room for the duration of all discussion on such items. (All members' register of interests are available on the Sandy Town Council website or on application to the Clerk.)</i>
<i>This item is included on the agenda to enable members to declare new DPIS and also those who wish to do so may draw attention to their stated DPIS and also any non-declarable personal interests which they have declared under Sandy Town Council's adopted Code of Conduct and which may be relevant to items on the agenda.</i>
i) <i>Declarable Pecuniary Interests</i>
ii) <i>Personal Interests</i> | x |
| 3 Minutes of previous meeting
To receive the minutes of the Community Services and Environment Committee held on 10 June 2013 and to approve them as a correct record of proceedings. | <i>Previously circulated</i> |
| 4 Affordable Housing
To receive a presentation on affordable housing from Geoff Evans, Development Manager, Aragon Housing and to consider a | x |

Sandy Town Council

proposal to campaign for new affordable housing in Sandy (Cllr Aldis).

5 New Road

To consider a proposal to apply to CBC for match funding for pavement down the length of New Road as suggested in Town Council minutes of 29 July 2013.

✓

6 Orchard Road

To consider a campaign for weight restriction measures on Orchard Road as suggested in Town Council minutes of 29 July 2013.

x

7 Trees at Bedford Road Recreation Ground

To consider a report on the trees in Bedford Road Recreation Ground growing near Albion Court, which are protected by a Tree Preservation Order.

✓

8 Sandy Enhancement Group

To consider a request from SEG to plant hedging/trees at Bedford Road Recreation Ground (Cllr Aldis).

x

9 Street Naming and Numbering

To consider a request from Central Bedfordshire Council with regard to street naming at Station Road. (Correspondence only attached).

✓

10 One Way for East Road

To consider a proposal to campaign for a one way system on East Road (Cllr Aldis).

✓

11 Street Lighting

To consider a report in respect of work on the Town Council's street lighting costing £6,950.

✓

12 S106 Arts Funding

To consider ideas for use of S106 funds for public art arising from the Tesco development at New Road, Sandy.

✓

13 Pride in Sandy Day 27 September 2013

To receive an oral report on arrangements for Pride in Sandy event on 27 September 2013.

x

Sandy Town Council

REPORTS

5 New Road Clerk's Report

At a meeting on 29 July 2013 Sandy Town Council agreed to give consideration to a proposal to apply to CBC for match funding for pavement along the length of New Road to the A1.

The request for pavement along the length of New Road was considered during consultations on the Biggleswade and Sandy LATPC refresh which took place in 2012 but has not been included for funding in the near future as it did not meet the priority criteria.

Match funding is available to some parishes from CBC's Local Transport Plan Rural Area Matched Fund. A total of £375,000 is being made available during 2014/15 to match fund schemes put forward by parishes which focus on integrated transport schemes. The scheme is intended for rural areas. The criteria for match funding are available on the CBC website, at first sight it is difficult to see how the request for pavement in New Road could comply with these criteria. Also the project would be an expensive one and parishes are expected to contribute up to £50,000 of the cost of projects. The greater the parish contribution the greater the chance of success. The deadline for applications for 2014/15 was 31 July 2013 (two days after the STC meeting at which the resolution was approved) therefore this scheme could only be considered for 2015/16.

A further consideration is whether it is advisable to encourage pedestrians to walk all the way to the end of New Road to then cross the A1. Alternative pedestrian routes are directed towards the footbridge which is a safer crossing point and the lack of pavement may encourage walkers to use these footpaths.

Sandy Town Council

7 Bedford Road Recreation Ground - Trees Deputy Clerk's Report

The Town Council is continually contacted by some of the residents of Albion Court whose properties have a boundary with Bedford Road Recreation Ground about the Lime and Maple trees which grow adjacent to the boundary. The resident(s) would like the trees to be less dense (crowns of the trees thinned to allow more light) and the trees to be cut back closer to the metal fence line, so that growth never goes further than the individual gardens wooden fence (which is approximately 1 metre closer to the properties than the metal fence line).

One of the residents from Albion Court who has communicated with the Town Clerk has said that they will pay for the work to the tree nearest to their property. The resident could make an application to Central Bedfordshire Council to carry out tree work to the tree and then CBC would have to consult with the Town Council about the application, before they made a decision.

The alternate Lime and Maple trees were initially planted approximately 1.8 metres from the boundary line and the trunks are now between approximately 1.2 metres and 1.5 metres from the boundary line.

Members may recall that Bedford Road Recreation Ground is within Central Bedfordshire Council's conservation area for Sandy. In addition the Lime and Maple trees are protected by Tree Preservation Order No.20, 2002 from Mid Beds District Council (Central Bedfordshire Council) and all tree works have to be approved by the planning section of Central Bedfordshire Council.

Below is what can be found on the Central Bedfordshire Council website about Tree Preservation Orders (TPO).

<http://www.centralbedfordshire.gov.uk/planning/trees-and-landscaping/default.aspx> *The objective of a TPO is to protect trees that make a significant impact on their surroundings, for example, if they form an important feature within the local landscape, or if they have an historical association with the local area.*

A TPO can be made in respect of an individual tree, a group of trees or woodland including hedgerow trees but not hedges, bushes or shrubs.

Exceptions: The removal of dead branches from living trees has been included in the list of excepted work, work to dangerous trees is also excepted to the extent that such works are urgently necessary to remove an immediate risk of serious harm, although notice should still

Sandy Town Council

be given. Removal of dying trees are no longer excepted and you must gain permission from Central Bedfordshire Council.

The properties in Albion Court started to be occupied in 2007. The Town Council has arranged for work to be undertaken to the trees on two occasions in the last five years and tree work was undertaken in the Autumn of 2008 and further work in the Summer of 2012. The work to be carried out to the alternating line of Lime and Maple trees was identified by the planning section at Central Bedfordshire Council after requests from Sandy Town Council in 2008 and 2011 for CBC to inspect if any works are required to the line of trees. Far more tree work was required to be undertaken in 2008 as no tree work had been undertaken to these trees for a number of years, the tree work identified and then undertaken in 2012 was far less than in 2008 as it was only a few years since the previous work had been completed.

The tree work identified and subsequently undertaken in 2008 is attached. The tree work identified by Central Bedfordshire Council and subsequently undertaken in 2012 was as follows:

Sycamore (Maple) removal of dead wood.

Limes near Albion Court have their basal and epicormic growth removed to a height of 5 metres and regrowth from old pruning points over the gardens shortened back.

The Town Council plans to make a request in 2015 to the planning section of Central Bedfordshire Council to ask for the trees to be inspected again on a three-year cycle as recommended by the planning section, so as to identify any necessary work.

To prune the trees back to the metal fence line (approximately 1.2 – 1.5 metres from the tree trunk and approximately 1.8 metres from the planting position), would require a significant amount of crown reduction of one side of each of the trees to be removed and would result in the trees being unbalanced. If all four sides of each of the trees were reduced to the same length as the distance to the metal fence side, this would have a significant impact on the local surroundings.

Significant pruning of any of the branches could result in an insufficient amount of foliage being left to support the individual branch, large areas of the main branch wood may become dysfunctional and open to decay fungi, which could lead to branch die-back.

As mentioned above the trees are protected by a Tree Preservation Order (TPO) because the trees bring amenity value to the surrounding area. The order makes it an offence to cut down, uproot, prune, lop or damage the tree(s) in question without first obtaining Central

Sandy Town Council

Bedfordshire Council's consent.

Recommendation that the trees in Bedford Road Recreation Ground are regularly monitored by the Town Council staff as they currently are and that the planning section of Central Bedfordshire Council is contacted in 2015 to ask them to arrange for an inspection of the trees.

Members are requested to decide on steps to be taken with regard to the trees growing in Bedford Road Recreation Ground adjacent to Albion Court.



Reference number BRG/02.

RECEIVED
16 MAY 2008

Priory House,
Chicksands,
Shefford,
Beds
SG17 5TQ

Gary Alderson
Director of Environmental & Planning
Services

Mrs S Foster
Clerk to Sandy Town Council
10 Cambridge Road
Sandy
Beds
SG19 1JE

please ask for
direct line
e-mail
fax no
web-site
your reference
our reference
date

R Morwood
01462 611338
bob.morwood@midbeds.gov.uk

TPO/14/26
15 May 2008

Dear Sue,

With reference to our telephone conversations, please find enclosed a plan and schedule for the trees at Bedford Road Recreation Ground. I hope that this is helpful to the Town Council.

As you know, the trees are protected by a Preservation Order and you would need to apply for consent to carry out the work. Enclosed are forms but these could be downloaded from our website.

Best wishes

Bob.

Bob Morwood
Tree and Landscape Manager



Bedford Road Recreation Ground, Sandy.

Number	Species	Condition and Comments
1	Lime	Fair condition. Remove all deadwood and epicormic shoots.
2	Sycamore	Poor condition. Extensive decay and dieback. Fell (No TPO)
3	Sycamore	Poor to fair condition. Remove all deadwood.
4	Lime	Fair condition. Remove all deadwood and epicormic shoots. Raise crown over Albion Court to give 6m clearance.
5	Sycamore	Fair condition. Remove deadwood.
6	Lime	Fair condition. Remove deadwood and epicormic roots.
7	Sycamore	Fair condition, widespread crown. Remove all deadwood.
8	Lime	Fair condition. Remove all deadwood and epicormic shoots.
9	Sycamore	Fair condition. Remove all deadwood; shorten low branches over pitch by 2-3 metres.
10	Lime	Fair condition. Remove all deadwood and all epicormic shoots; shorten branches over garden back to fence and balance crown on pitch side of tree.
11	Sycamore	Fair condition with a wide-spread crown. Remove all deadwood; reduce extent of crown all round by 15% to re-shape tree.
12	Lime	Fair condition. Remove all deadwood and epicormic shoots; reduce extent of crown by 15% (especially over garden) and raise crown to give 6-7 metres clearance.
13	Sycamore	Fair condition with a widespread crown. Remove deadwood; reduce extent of crown over gardens by 50%; reduce extent of crown on pitch side by 20% to re-shape tree.
14	Lime	Fair condition. Remove deadwood and epicormic shoots; raise crown to give 6-7 metres clearance; reduce branch over garden by 50%.
15	Sycamore	Fair condition. Remove deadwood; reduce crown spread by 25-30%, especially on house side.
16	Lime	Fair condition. Remove deadwood and epicormic shoots; reduce extent of lower crown by 50%, especially over gardens.
17	Sycamore	Fair condition. Remove deadwood.

The trees have not had much maintenance over the years and now that Albion Court has been built, regular inspections and any necessary work should be carried out. A three-year cycle of inspections should, ideally, be put in place.

Reference number.

BRG / 01

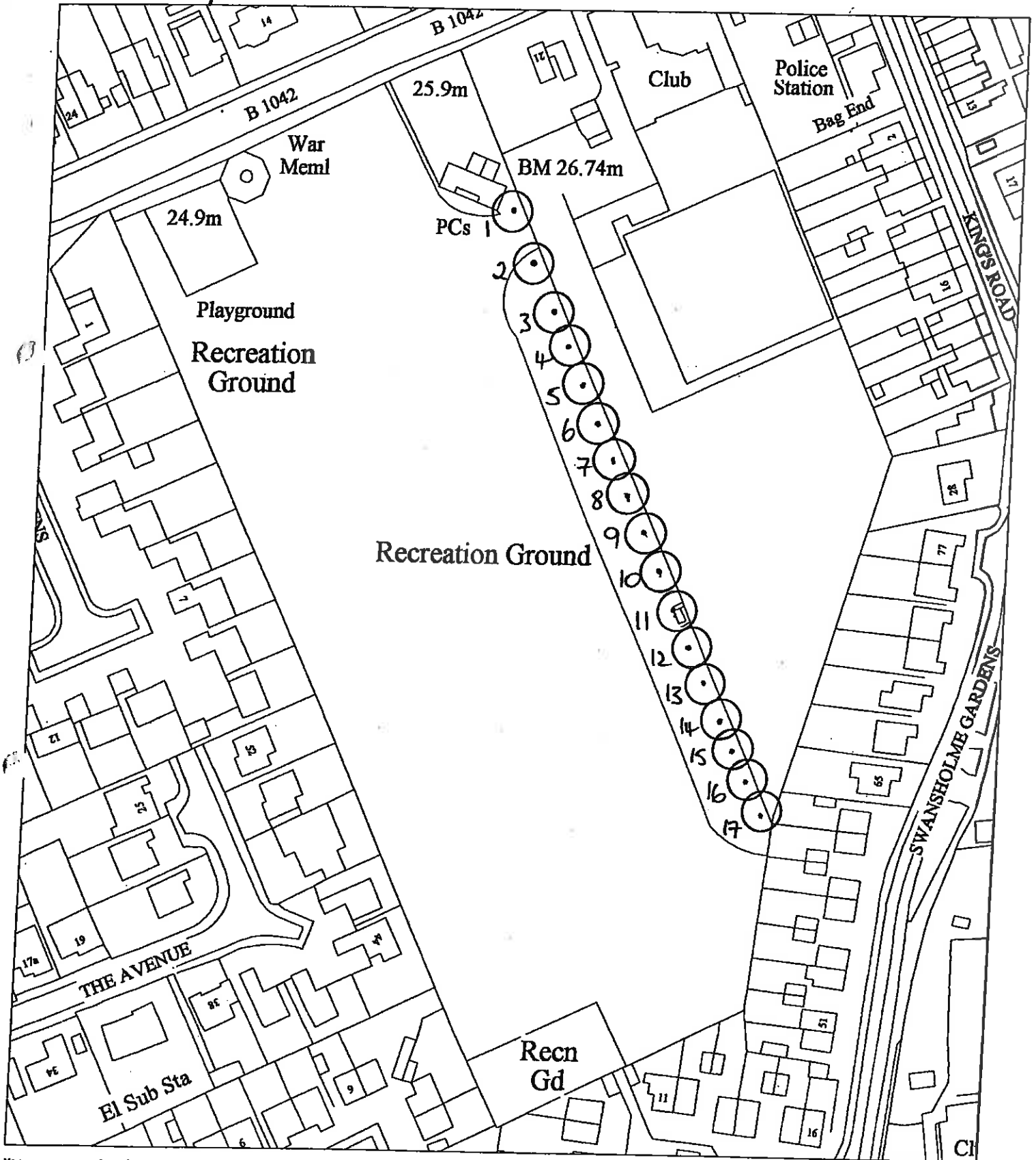

Maps are reproduced from Ordnance Survey mapping with the permission of the Controller of HMSO, (c) Crown copyright. Unauthorised reproduction infringes Crown copyright and may lead to prosecution or civil proceedings.

Sandy Town Council

9 **Street Naming and Numbering**

The Town Council has been contacted by Building Control at Central Bedfordshire Council about the street naming of the land off, Station Road, Sandy, SG19 1AW. **Copy of correspondence attached.**



Peter Keates
Head of Building Control &
Albion Archaeology

please ask for Anne Smith
direct line 0300 300 5504
e-mail building.control@centralbedfordshire.gov.uk
web-site www.centralbedfordshire.gov.uk

Ms Delia Shephard
Clerk to Sandy Town Council
Council Offices
10 Cambridge Road
Sandy
Beds
SG19 1JE

your ref
our ref CB/SN/13/0044
date 28 August 2013

Dear Ms Shephard

Local Government Act 1985
Street Naming and Numbering
Location: Land off, Station Road, Sandy, SG19 1AW
Proposal: Postal addresses for 36 dwellings

I write to inform you that the Council has received the above application for Street Naming for which a new street name is required.

The developers have not put forward any preferences for the new street name therefore could you discuss the subject at your next Town Council meeting and inform me of any proposals you would like considered.

Please note that we are unable to accept the same or similar names already in existence in the area.

Yours sincerely

Peter Keates
Head of Building Control & Albion Archaeology

19 AUG 2013

HOUSE TYPE SCHEDULE	
289-Allweath - 3B 2ST House	6
289-01 Sandy - 4B 2.5 ST House	1
289-02 Sandy - 3B 2.5 ST House	3
289-03 Sandy - 4B 2.5 ST House	3
289-04 Sandy - 4B 2.5 ST House	2
289-05 Sandy - 4B 2.5 ST House	2
289-06 Sandy - 4B 2.5 ST House	8
TOTAL MARKET UNITS	23
289-Abwelon 1 - 2B 2ST FOG	2
289-Abwelon 2 - 2B 2ST FOG	1
AF38(8) - 3BSP 2ST House	10
TOTAL HA UNITS	13
GRAND TOTAL	36

C 3407743 Pkcs 21 & 24 boundary amended.
 B 0760713 Pkcs 11-18 & 24-30 amended.
 A 0606713 Pkcs 1, 30-35 garage created.
 11 Main Street
 Lydbington
 Rutland
 LE15 9LR
 Louise Michelle Cooper - Architect
 Tel/Fax 01572 820185
 Mobile 07885 843743

Client: Linden Homes (Midlands)
 Title: Land off Station Road Sandy, Bedfordshire
 Drawing: Planning Site Layout
 Date: 19/08/13

Scale: 1:500	Sheet Size: A3	Date: 07/03/13	Drawn: LMC
Drawing Number: 289-SK-02			Rev: C

Do not scale or change printed drawings. The liability for the accuracy of the information shown on this drawing shall remain with the client. It is the client's responsibility to ensure that all necessary permissions are obtained for the use of this drawing.

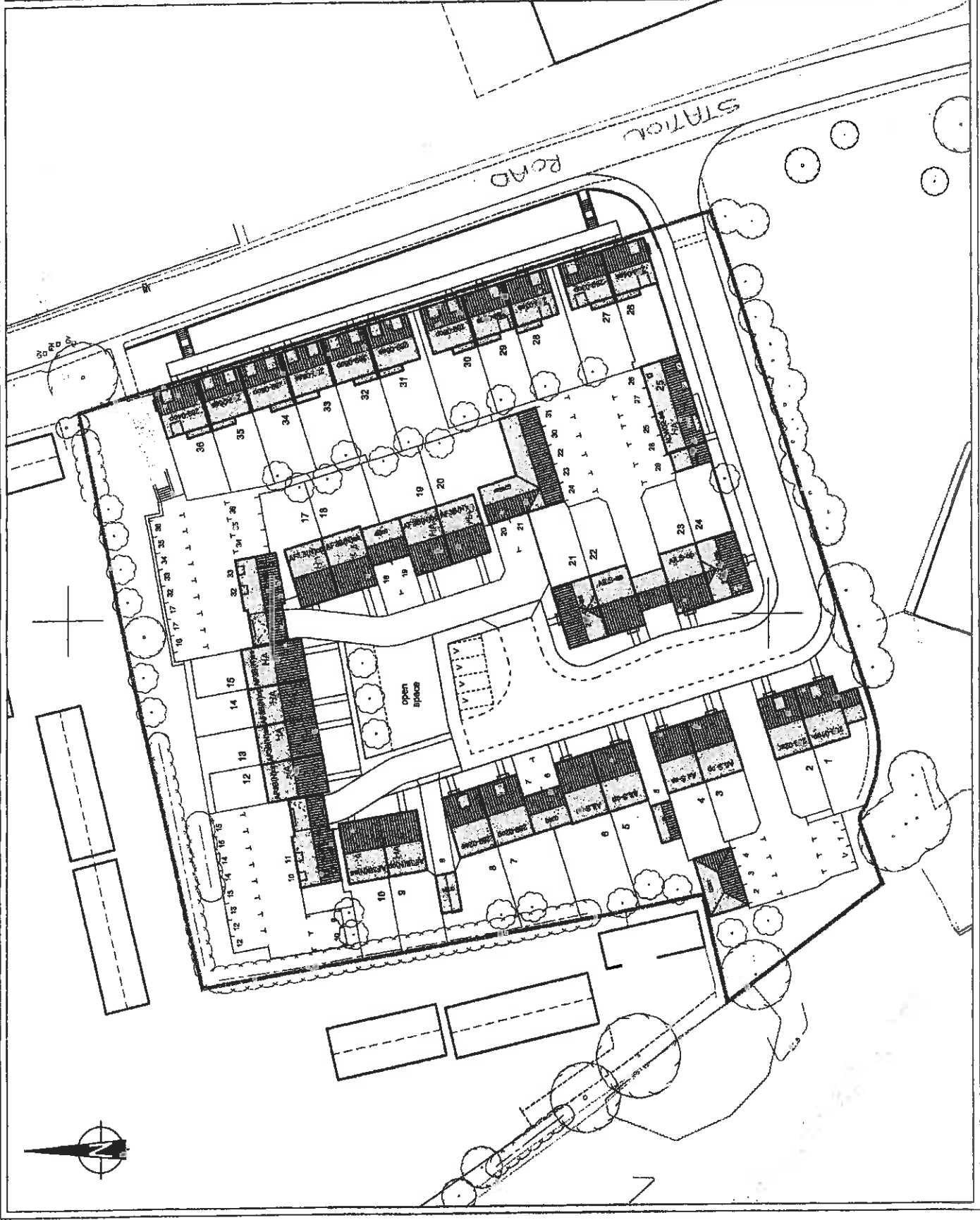

Sandy Town Council

10 **One Way for East Road Report from Cllr Aldis**

It has been suggested that East Road should be one way from St Neots Road around to the junction with Longfield Road. Longfield Road to St Neots Road would also become one-way. Currently traffic is prohibited from entering Longfield Road from St Neots Road by "No Entry" signs but the road is not restricted. Glebe Road would continue to be two way throughout its length as at present.

The advantages of this idea are seen as providing more on road parking provision and better highway safety as there would be an avoidance of doubt in Longfield Road as to whether it was one way or not. The dangerous access off East Road onto St Neots Road would also be eliminated.

The disadvantages are seen as an increase in the amount of traffic exiting from Longfield Road next to the corner shop and near the already busy junction of West Road near the zebra crossing. Additionally concerns have been expressed about the narrowness of Longfield Road and the inadequate width of the pavements to accommodate the volume of pedestrian traffic and the width of mobility scooters or buggies. The scheme would also not prevent the use of East Road as a "rat run" by commuters to avoid the build-up of queuing traffic at the town centre roundabout.

An informal consultation exercise has been carried out in the local area via a political circular. There have been very few objections to the suggestion.

Members are asked to consider whether they would support the proposal and what amendments (if any) that they would like to see added to the scheme. If agreed a recommendation would go forward for consideration by Central Bedfordshire Council Highways Department. There would be a cost for design, formal consultation, signage, Road Traffic Orders etc.

Sandy Town Council

11 Street Lighting

Deputy Clerk's Report

Members may recall that at the Town Council meeting on the 1st August 2011 (**50/2011-12**) a report from the Deputy Clerk and two recommendations from the PP&OS Committee made at a meeting on 18 July 2011 were received and considered.

It was resolved: to authorise replacement of 17 streetlight columns as described in the Deputy Clerk's report at a cost of £26,160 to be funded from the capital account.

It was resolved: to authorise cleaning, painting (and earthing if necessary) of 7 street lights as described in the Deputy Clerk's report at a cost of £525 to be funded from the revenue account.

Quotation 1. One of the 7 street lights to have work undertaken on the 1st August 2011 was Western Way opposite Manor Road, concrete column, probably hit by a vehicle, twist bracket and establish if it can be fixed. This column (S5 Western Way) was unable to be repaired. A quotation of £1600 to remove and replace the column in Western Way is attached.

Quotation 2a. Jenkins Pavilion. The Town Council's street lighting engineer has advised that the lighting installed is allowing water in to the lanterns and causing them to fail, he also advised that the number of street lights located near the Jenkins Pavilion is excessive. A quotation of £1400 is attached to fit 4 replacement lanterns, switch off six columns and re-light column 1.

Quotation 2b. Jenkins Pavilion, seal off and remove the six remaining switched off columns. A quotation of £750 is attached.

Quotation 3. Brook End (S1) Beeston, the Town Council's street lighting engineer has recommended that column be replaced as the top assembly is unsafe. A quotation of £1600 is attached.

Quotation 4. East Road (S3), following a site meeting with the Town Council's street lighting engineer and the Deputy Town Clerk urgent works were carried out to remove the existing light, the cost for the work that has been undertaken was paid out of the lighting maintenance budget. A quotation of £1600 to supply and fit a replacement column is attached.

The total cost to have all the work mentioned above is £6950.

The current lighting maintenance budget has £1510 available after all other known bills for this financial year. If the £1510 was used towards

Sandy Town Council

any of the above quotations, this would leave no money available within this budget code for any emergency works that may be needed in the rest of the financial year for the Town Council's street lighting. Members are reminded that more than half of the financial year remains and on a number of occasions in previous year's a street light(s) has needed to be replaced due to cold weather splitting open the column.

Members are requested to decide if they would like to proceed with any of the five quotations. Members are reminded that the contingency budget for this financial year has already been committed, members could also consider using the capital budget or defer the item so that it forms part of the Town Council's budgeting process for 2014/15.

TERRY C. SEYMOUR

ELECTRICAL INSTALLATIONS

88 Norton road, Stotfold, Hitchin, Herts SG5 4PG • Tel/Fax: (01462) 730350 • Mobile: 07860 327437

Domestic
Industrial and
Commercial Electrician
Part 'P' Reg'd Installer

ESTIMATE

Sandy Town Council.
10 Cambridge Road
Sandy
Beds. SG19 1JE

RECEIVED
2 SEP 2013

No: 2380

Date: 29.08.2013

Dear Sirs,

Please find below our estimate for column S3 East Road, Sandy.

To supply and fit one 5mtr. galvanised tubular steel column, complete with new 36 watt 'Libra' PL lantern and photo-cell, in place of old B.T. telegraph pole.

To carryout all internal wiring and switching as necessary, and all excavation and reinstatement works.

To liaise with and pay all EDF Energy incurred charges and leave the new column in full working order.

for the sum of £1600.00 plus VAT current.

Yours sincerely,

Terry C. Seymour.

TERRY C. SEYMOUR

ELECTRICAL INSTALLATIONS

88 Norton road, Stotfold, Hitchin, Herts SG5 4PG • Tel/Fax: (01462) 730350 • Mobile: 07860 327437

Domestic
Industrial and
Commercial Electrician
Part 'P' Reg'd Installer

ESTIMATE

Sandy Town Council.
10 Cambridge Road
Sandy
Beds. SG19 1JE

RECEIVED
2 SEP 2013

No: 2381

Date: 29-08-2013

Dear Sirs,

Following on from our recent works to the 'out of light' column S1 in Brook End, Beeston, it was found that the top of the column casting and associated bracket spigot have corroded and split, causing the top assembly to become unstable - a photograph showing the problem is enclosed. for this reason on safety grounds, we would recommend that this column be duly replaced at the council's convenience.

We would estimate that the cost of a new 5mtr. galvanised steel column, complete with new 36 watt low energy PL lantern and all internal wiring and switching devices, excavation and reinstatement works, together with EDF Energy incurred column transfer charges to be £1600.00 plus VAT current.

We await your instructions accordingly.

Yours sincerely,

Terry C. Seymour



COLUMN ST, BROOK END BEESTON,
TOP OF COLUMN SPIGOT CRACKED AND
BADLY CORRODED.

TERRY C. SEYMOUR

ELECTRICAL INSTALLATIONS

88 Norton road, Stotfold, Hitchin, Herts SG5 4PG • Tel/Fax: (01462) 730350 • Mobile: 07860 327437

Domestic
Industrial and
Commercial Electrician
Part 'P' Reg'd Installer

ESTIMATE

Mr. Jonothan Whitehurst.
Sandy Town Council
10 Cambridge Road
Sandy
Beds. SG19 1JE

No: 2310 - Copy

Date: 25.11.2011

Jonothan,

re: Column S5 Western Way, Sandy.

Following on from our discussion about where we tried to fit a metal sleeve to this column at bracket height to bring the column back to the correct angle, I can confirm that the existing concrete bracket has corroded to the actual column and a severe crack is apparent at high level, running round the top of the bracket. This has caused water ingress into the concrete further, causing some steel reinforcing rods to become exposed. Because of this, we would recommend to you that you consider replacing this complete column in the near future.

With this in mind, we can supply, wire and fit one 5mtr. galvanised tubular steel column, complete with one Industria Libra lantern(as previously used) and carry out all ground works, together with EDF column transfer charges:

for the sum of £1600.00 plus VAT current.

We will leave the column in full working order. The existing concrete column will be removed and disposed of accordingly at the correct disposal site.

Yours sincerely,

Terry C. Seymour.

TERRY C. SEYMOUR

ELECTRICAL INSTALLATIONS

88 Norton road, Stotfold, Hitchin, Herts SG5 4PG • Tel/Fax: (01462) 730350 • Mobile: 07860 327437

Domestic
Industrial and
Commercial Electrician
Part 'P' Reg'd Installer

ESTIMATE

Sandy Town Council.
Council Offices
10 Cambridge Road
Sandy
Beds. SG19 1JE

No: 2318 - copy

Date: 26.01.2012

*J. House can
you get requests for
these — we need to address
D.*

re: Sunderland Road facilities.

for the attention of Mr. J. Whitehurst.

Dear Sir,

Thank you for your recent enquiry regarding the proposed upgrading of the water damage lanterns around the approach/car park areas of the Pavilion. Please find below a detailed list of proposed works, together with a price we hope you will find acceptable.

To disconnect and remove four existing post mounted lanterns and to supply, wire and fit four 'Industria' Arc 80 replacement lanterns, complete with 70 watt white light metal Halide lamps - as previously used - and leave in full working order.

To switch off the remaining six columns per our discussion with Jonothan, and re-light column 1 accordingly. All for the sum of £1400.00 plus VAT

If the council wish us to seal off and remove the six remaining switched off columns accordingly, this can be achieved at an additional cost of £750 plus VAT.

Yours sincerely,

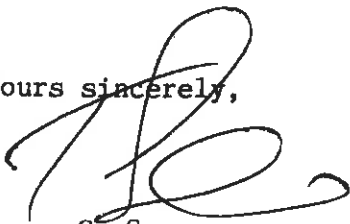

Terry C. Seymour.

Sandy Town Council

12 S106 Arts Funding Clerk's Report

At the last meeting of PF&R Committee it was resolved that members of that committee should consider making a recommendation to Town Council about the use of S106 arts funding from the Tesco Development. However, the council's adopted guide to its scheme of delegations indicates that arts funding and projects falls within the remit of the Community Services and Environment Committee.

The S106 agreement for Tesco permits the use of funding for performances as well as concrete art objects and given the sum involved this is more likely to be a realistic objective. Correspondence is attached from Cllr Sharman.

It is suggested that at the next Town Council meeting such a task and finish working group is elected and the Council is asked to transfer responsibility for use of the S106 arts funding to the Community Services and Environment committee.

Cllr. David Sharman

21 Falcon Close

Sandy

Bedfordshire

SG19 2TA

01767 683868

26th August 2013

Dear Delia,

Ref: some thoughts on the use of Section 106 money for Public Art.

Though the sum in question is quite small, I do feel that a local artist (in whatever medium and whether amateur or professional) could produce something suitable for the sum available. The people I have in mind are, as examples; the art group that meets at The Roundabout Club, Aquarius Stained Glass and Max McMurdo. There are I imagine also many others. I for one, with the appropriate design input, could produce a piece of stained glass for much less than the amount involved.

Apart from the above, I would give my support to an art based event; for example 'workshops' open to the public, a talk on an art subject also open to all or an exhibition open to all people from Sandy above the age of 14.

It would seem sensible to set up a working group, of a small number of councillors together a few interested members of the public.

While the amount is small, I feel we should ensure that whatever we do will benefit the town.

Best Wishes

